



1/11-15 Chapman Street Gymea NSW

2 1 1

Occupying a prized, and private elevated ground-floor setting within a popular well-maintained complex featuring lift access, and located just moments to Gymea Village shops, cafes and train station, this beautifully presented, peaceful apartment offers total convenience and easy-care living. With level walk convenience to Gymea village, the ideal floorplan encapsulates open-plan, living and dining zones leading to the covered entertainer's balcony, sizeable bedrooms and modern kitchen and bathroom. Perfectly placed to enjoy all the lifestyle benefits that Gymea has to offer, this outstanding apartment presents an ideal buying opportunity whether downsizing, investing or entering the property market for the first time.

Features include:

[For full version visit the website](https://www.mitchellestateagents.com.au/8117348)

Type : Apartment
Price : Just Listed
Land Size : 95 sqm
View : <https://www.mitchellestateagents.com.au/8117348>



James Mitchell
0405 951 570

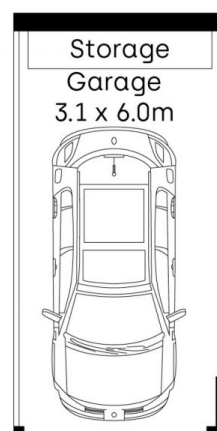
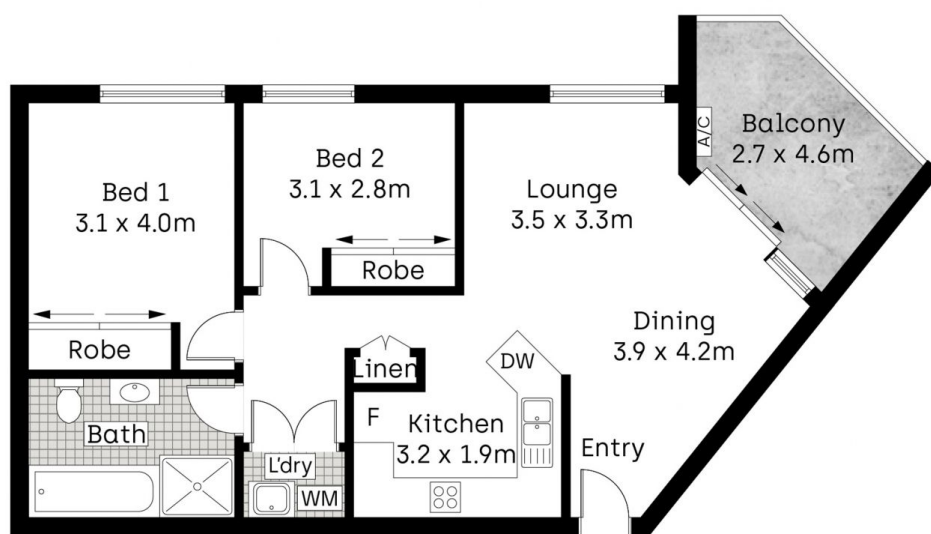

[Not In Position]

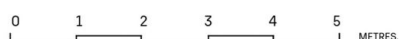

Whilst bwrn.com.au has made every attempt to ensure the accuracy of the floor plan contained here, measurements are approximate and no responsibility is taken for any error, omission, or mis-statement. This plan is for illustrative purposes only.

1/11-15 Chapman Street, Gymea

Mitchell Estate Agents