



2 Garvan Road Heathcote NSW

Corner site land area 1,921 m²*
Factory area of 1,000 sqm* + offices + mezzanine

For sale by tender, closing 12:00 pm Tuesday 1st October 2024

Positioned with premier exposure on the corner of Princes Hwy, and Garvan Road, this exceptional commercial opportunity is being offered for sale to the market for the very first time. Encompassing a substantial warehouse facility, with mezzanine, plus multiple offices and showroom spaces, secure fencing and significant designated parking/storage space.

Located in one of Southern Sydney's most tightly held industrial precincts, the property boasts dual street frontage to Princes Hwy south and north bound, and Garvan Road,

Price : Expressions of Interest
Building Size : 1229 sqm
Land Size : 1921 sqm
View : <https://www.mitchellestateagents.com.au/8101212>



James Mitchell
0405 951 570



Ground Floor

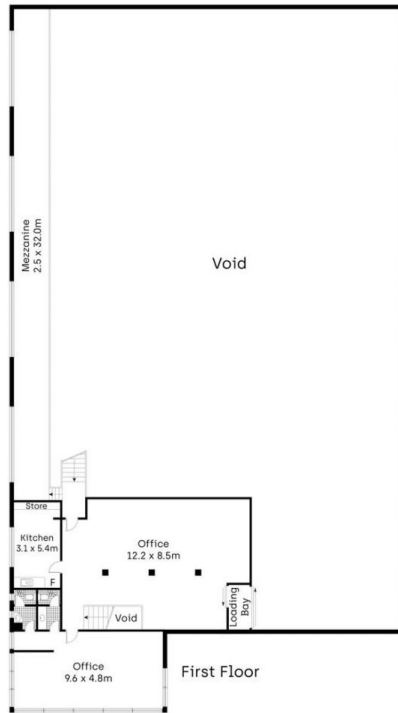

First Floor

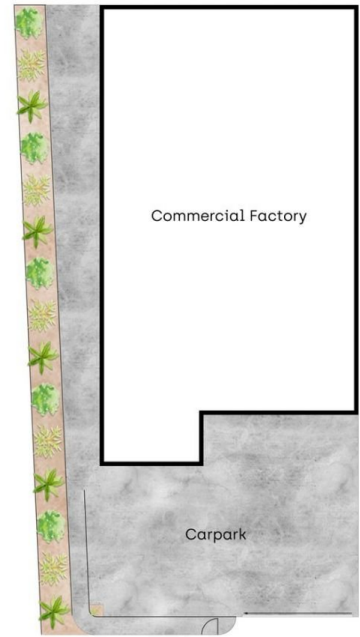

Site Plan



Whilst bwr.com.au has made every attempt to ensure the accuracy of the floor plan contained here, measurements are approximate and no responsibility is taken for any error, omission, or mis-statement. This plan is for illustrative purposes only.

2 Garvan Road, Heathcote

Mitchell Estate Agents